

PCE Drycleaner Contamination
Industrial Dry
(The Basics)
Cleaners

Presented by Paul H. Hayden, P.G., L.R.S., R.S.M.

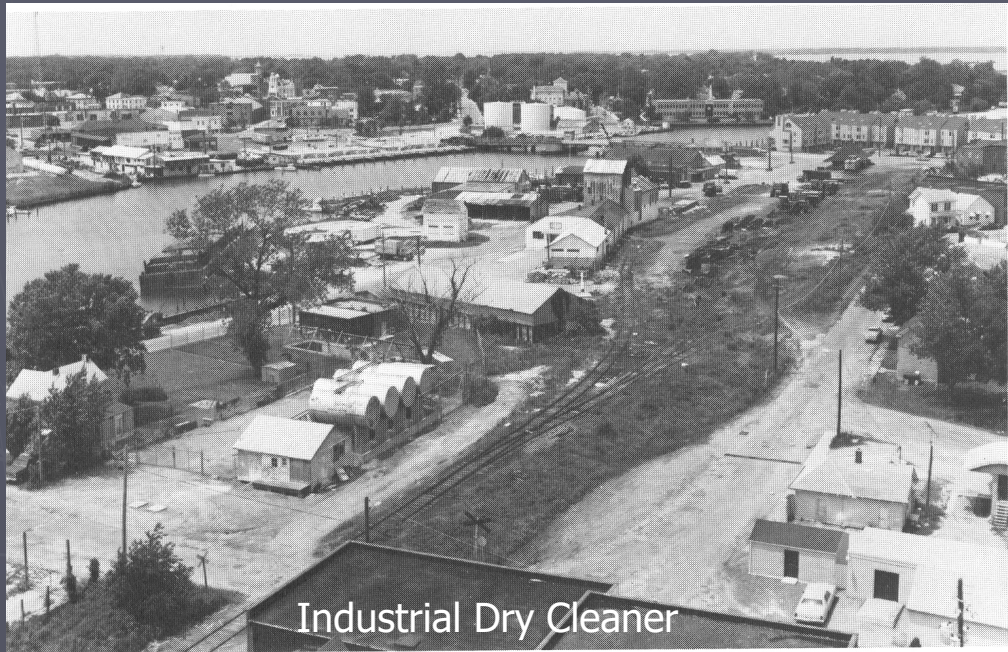

Industrial Dry Cleaners



Geo-Technology Associates, Inc.

Geotechnical and Environmental Consultants

- Founded in 1985
- 20 offices in New Jersey, Pennsylvania, Delaware, Maryland, Virginia, West Virginia, North Carolina, and Ohio
- Over 450 employees
- Clients include commercial and residential developers, investors, builders, banks, brokers, industry, government agencies, telecom, other engineers
- Hundreds of Phase I ESAs and other environmental studies performed every year, mostly related to property transactions and developments



Deep Harbour Case Study and Lessons Learned

Case Study

"Cleaner Contamination?"

- ▶ Historical Uses
 - Fertilizer Plant



Case Study

"Cleaner Contamination?"

- ▶ Historical Uses
 - Fertilizer Plant
 - Bulk Fuel Storage



Case Study

"Cleaner Contamination?"

- ▶ Historical Uses
 - Fertilizer Plant
 - Bulk Fuel Storage
 - Auto Repair/Junkyard



Case Study

"Cleaner Contamination?"

- ▶ Historical Uses
 - Fertilizer Plant
 - Bulk Fuel Storage
 - Auto Repair/Junkyard
- ▶ Adjacent Properties
 - Bulk Fuel Storage
 - Industrial Dry Cleaning



Case Study

"Cleaner Contamination?"



Case Study

"Cleaner Contamination?"



Case Study

"Cleaner Contamination?"



Case Study

"Cleaner Contamination?"



Case Study

"Cleaner Contamination?"

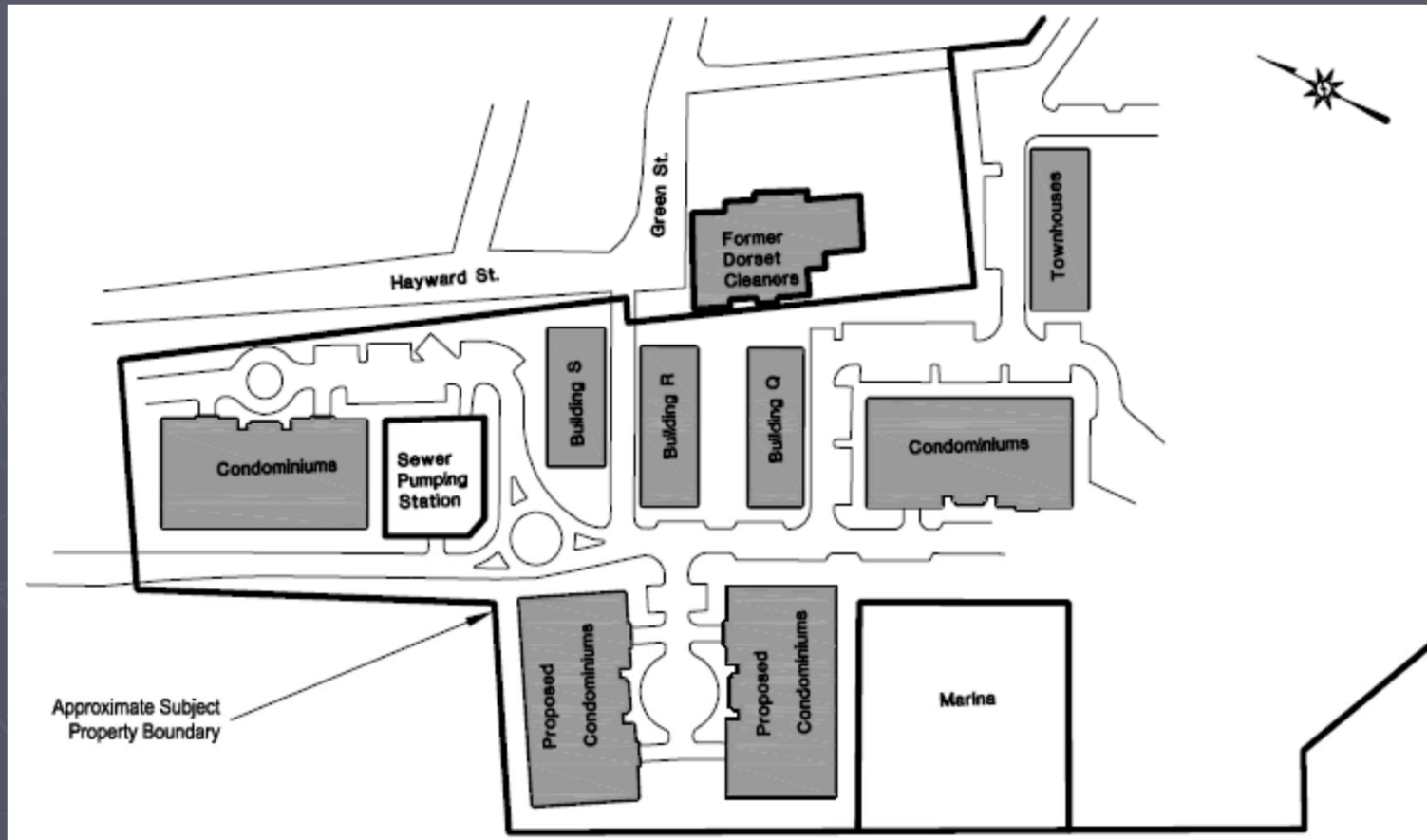

Case Study

“Cleaner Contamination?”



- ▶ Phase II ESA identified “minor contamination”
- ▶ Legal advice – no Voluntary Cleanup Program (VCP)
- ▶ Client acquires the property
- ▶ Full construction begins

Case Study

"Cleaner Contamination?"



- ▶ "Major" contamination found
- ▶ Changed legal counsel and entered the VCP
- ▶ Eventually, eight USTs, hundreds of linear feet of product piping, and over 6,000 tons of impacted soil were removed
- ▶ Now a "Responsible Party" (no public funds or BF Tax Credits available)
- ▶ Delay charges due to contamination
- ▶ Perception issues
- ▶ Potential reduction in sale price of residential units

Case Study

"Cleaner Contamination?"

- ▶ Worked with MDE to:
 - Address contamination



Case Study

“Cleaner Contamination?”

- ▶ Worked with MDE to:
 - Address contamination
 - Address public perception
 - Identify off-site issues impacting the site



Case Study

"Cleaner Contamination?"

- ▶ Worked with MDE to:
 - Address contamination
 - Address public perception
 - Identify off-site issues impacting the site
 - Implement a Remedial Action Plan



Case Study

“Cleaner Contamination?”

- ▶ Worked with MDE to:
 - Address contamination
 - Address public perception
 - Identify off-site issues impacting the site
 - Implement a Remedial Action Plan
 - Received Closure Letter



Case Study

"Cleaner Contamination?"

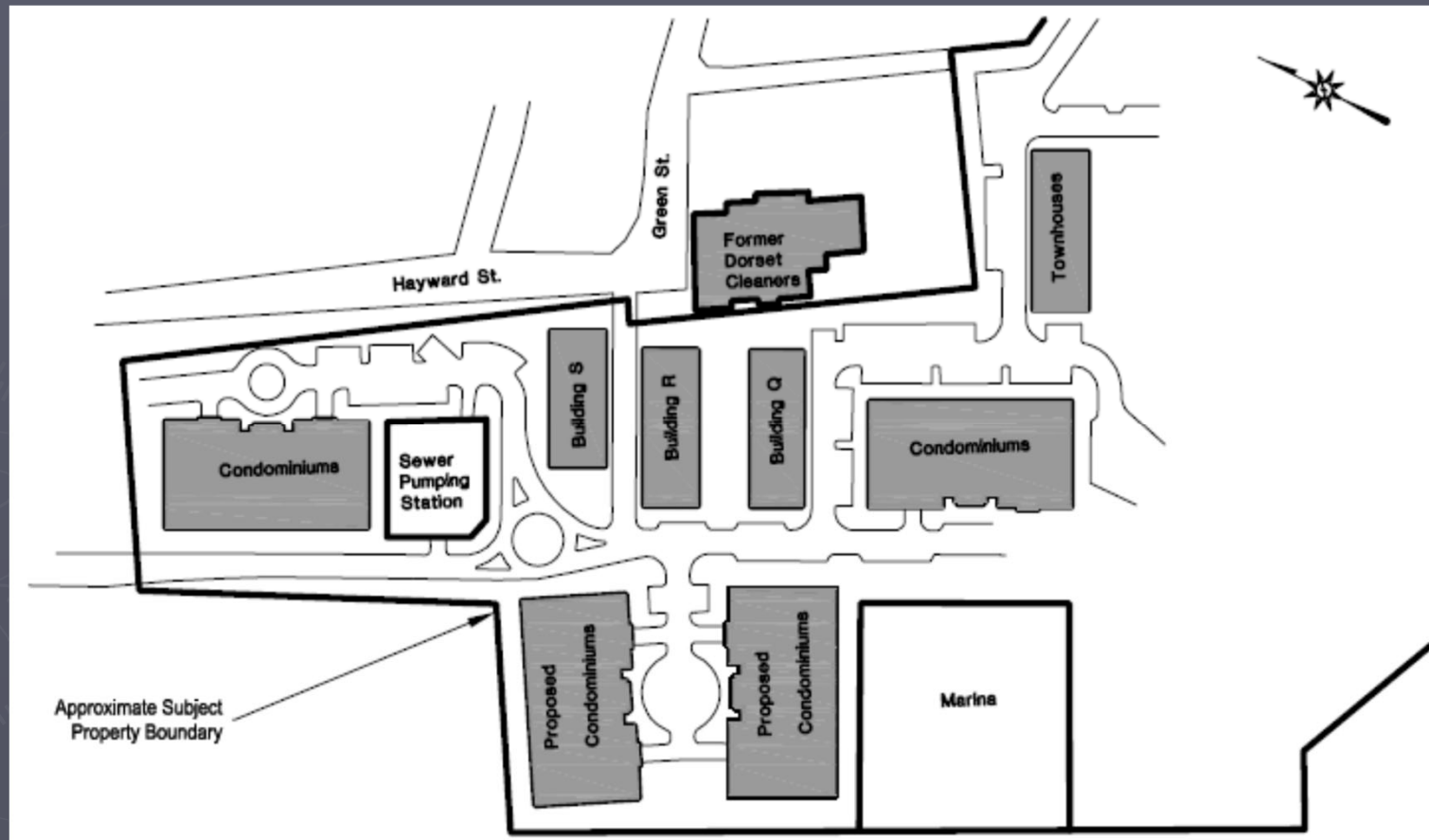

Case Study

"Cleaner Contamination?"



Case Study

"Cleaner Contamination?"



Case Study

“Cleaner Contamination?”

- ▶ Environmental remediation in excess of \$1.7 Million dollars
- ▶ WHY?
 - PCE groundwater treatment system
 - Remediated vapor issues in Buildings Q & R
 - Petroleum impacts (e.g. USTs, soil, piping, etc.)
 - Eliminated all remaining exposure pathways during the effort to get site closure



McCord Laundry and Cleaning, Inc. The Beginning



McCord Laundry and Cleaning, Inc. The Beginning

- ▶ 2012 Phase I ESA Opinion: “No environmental site assessment can eliminate all uncertainty and Professional judgment and interpretation are inherent in the process. It is not possible to eliminate all uncertainty with regards to environmental contamination. However, the information obtained and observations made during this assessment indicate that the risk of significant or widespread contamination or environmental problems with this site is moderate.”

McCord Laundry and Cleaning, Inc.

- ▶ Commercial Laundry from 1925-2009
 - Added industrial dry cleaning services in 1933



Historical photos courtesy of the Historical Society of Talbot County



Mc CONOS EASTON No. AFTER



McCord Laundry and Cleaning, Inc.

- ▶ Used Stoddard Solvent initially
 - Added a small PERC machine in Mid-1980s

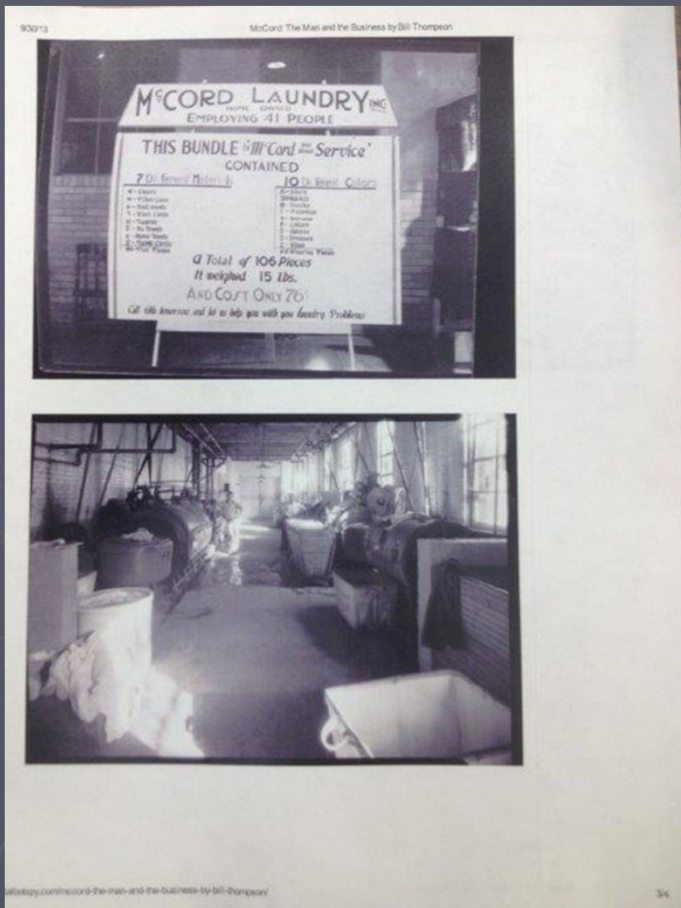

Brick Row built in 1885

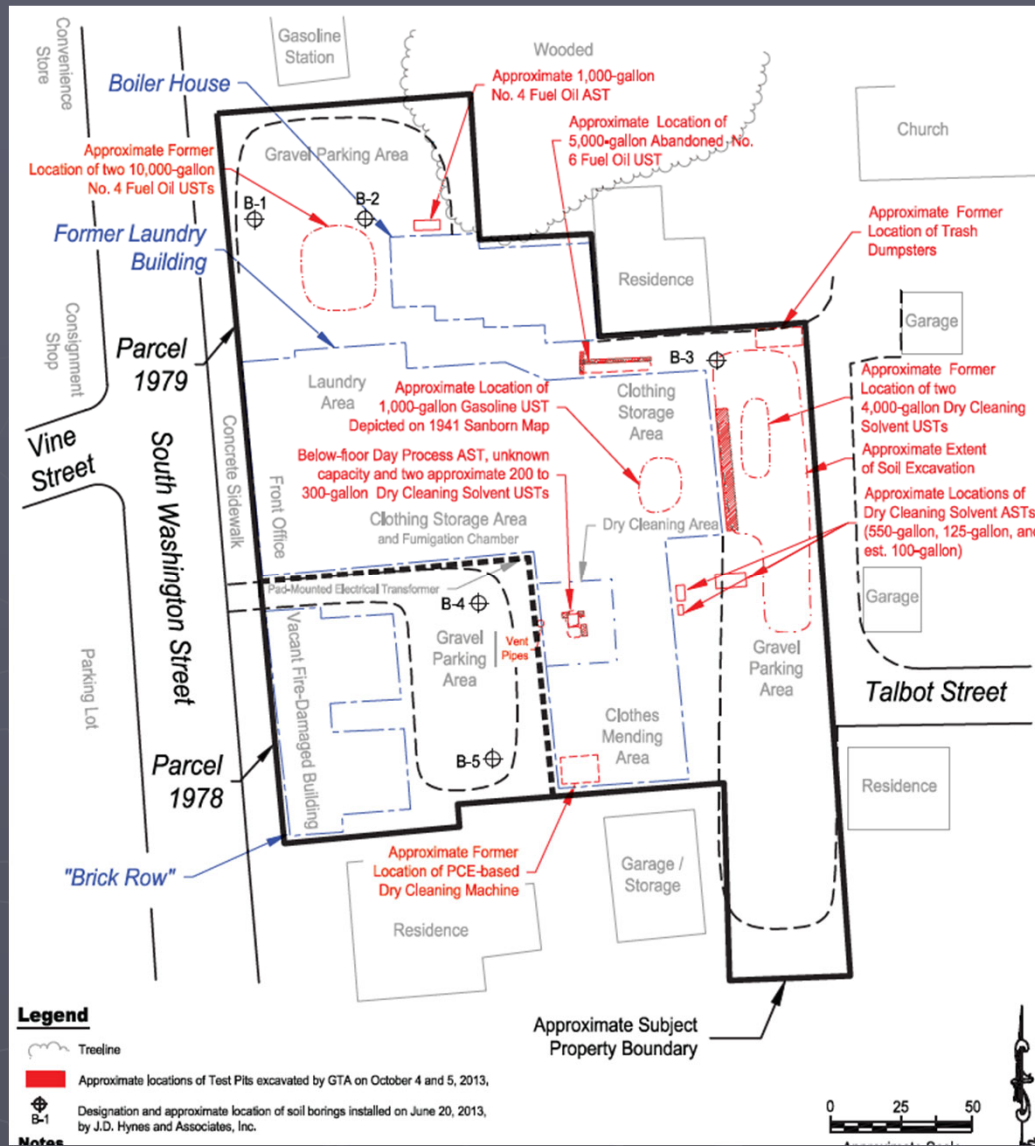

Stoddard Solvent USTs



McCord Laundry and Cleaning, Inc. Tour



McCord Laundry and Cleaning, Inc. Tour



McCord Laundry and Cleaning, Inc. Tour



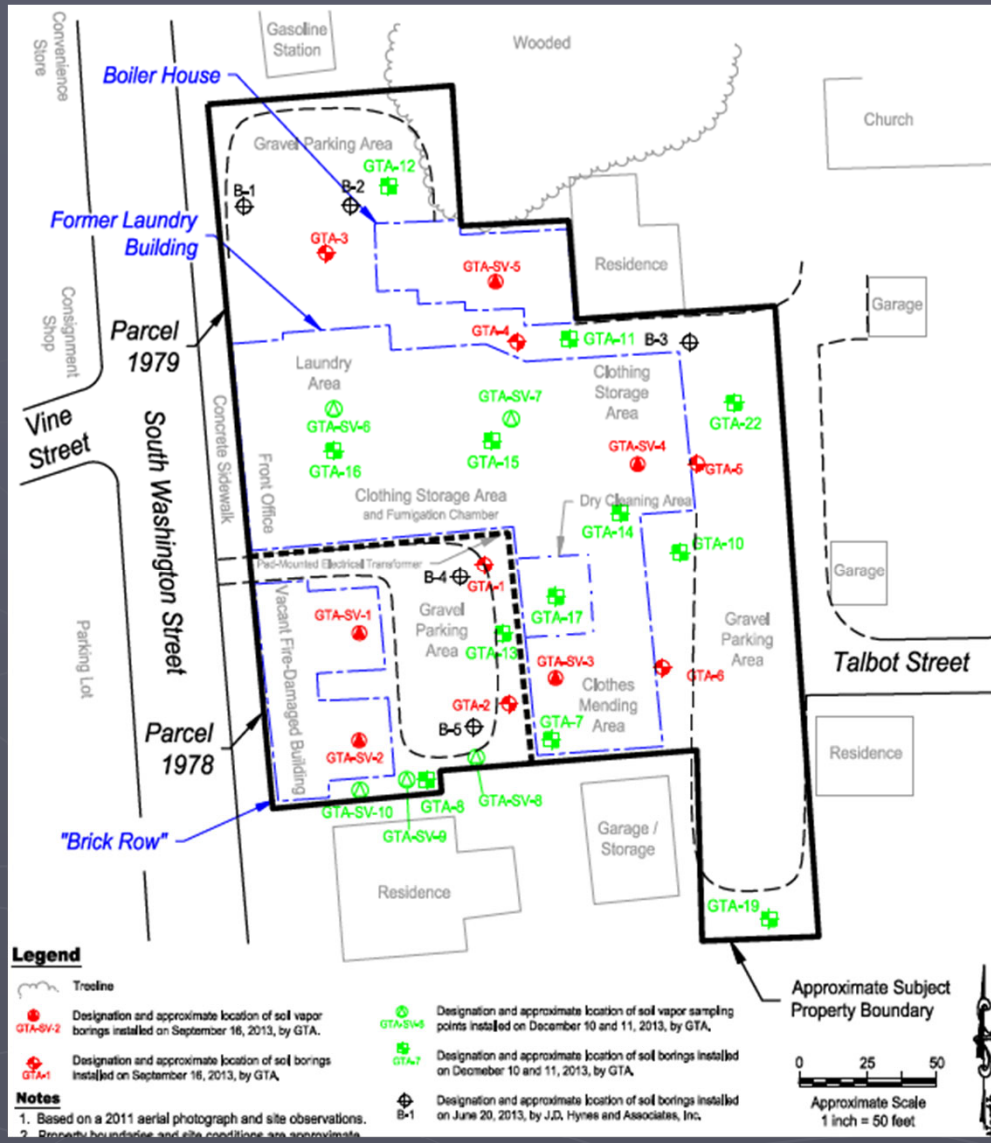

Corrective Action Plan Implementation

- ▶ Protection from impacted soil, groundwater, and soil vapor
 - Excavation and removal of impacted soil
 - Passive vapor mitigation system installation
 - Capping with MDE approved clean materials
 - Construction observation for correct CAP implementation
 - Post construction cap monitoring
 - Notification to MDE if future excavation is needed
 - Groundwater restriction

COURTYARD EXCAVATION

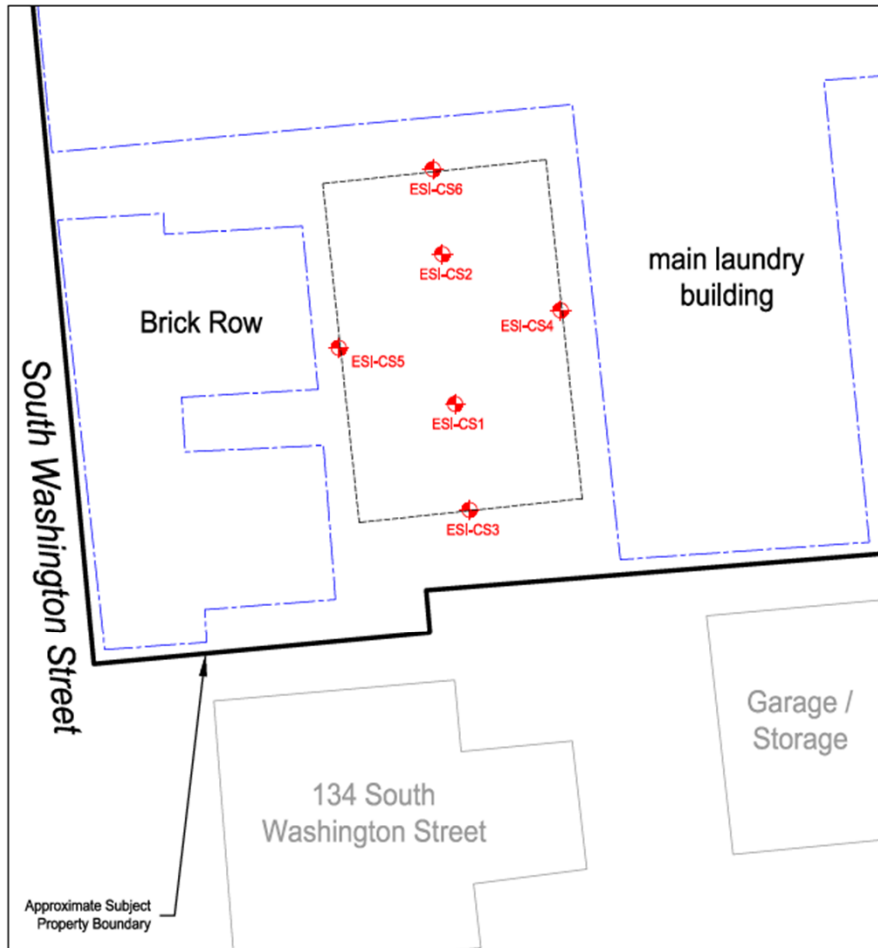

UST EXCAVATION

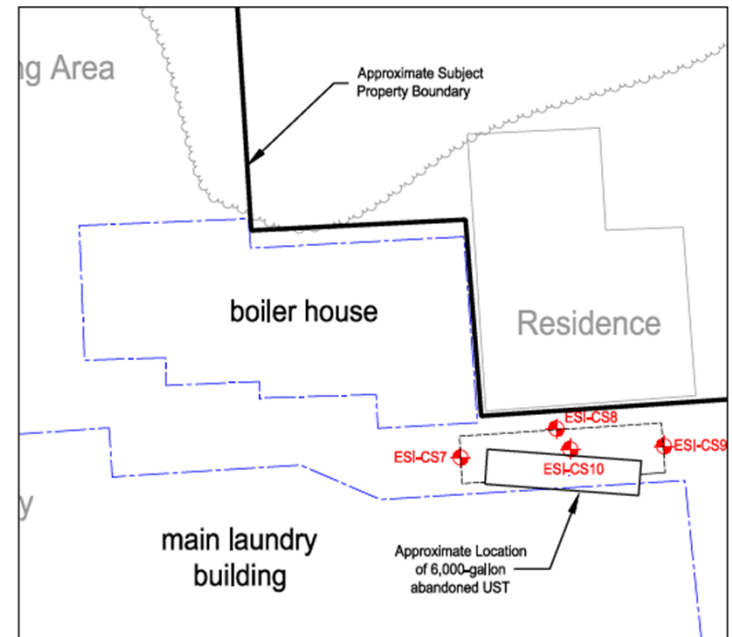

Legend

- Identification and approximate location of soil samples collected by GTA ESI on January 7, 8, and 23, 2015.
- Approximate limits of soil excavation activities.

Notes

1. Based on a 2011 aerial photograph and site observations.
2. Property boundaries, site conditions, and sample locations are approximate.

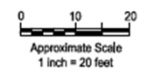

	GTA ENVIRONMENTAL SERVICES, INC. 14280 PARK CENTER DRIVE, SUITE A LAUREL, MARYLAND 20707 (410) 792-9446 or (301) 470-4470 FAX: (410) 792-7395 www.mragta.com © Geo-Technology Associates, Inc.	MCCORD LAUNDRY AND CLEANING, INC. EASTON, TALBOT COUNTY, MARYLAND CONFIRMATORY SAMPLE LOCATION PLAN
	PROJECT: 1321629ESI DATE: JANUARY 2016 SCALE: 1" = 20' DESIGN BY: ATM REVIEW BY: KPP FIGURE: 3	



Corrective Action Plan Implementation



Corrective Action Plan Implementation



~1,400 tons of impacted soil removed



Corrective Action Plan Implementation



Epro System III MB vapor barrier was installed in each building.



Corrective Action Plan Implementation



Corrective Action Plan Implementation



Corrective Action Plan Implementation



But wait... there's more



Approximate Location of Off-Site Sampling

Approximate Subject Property Boundary

Notes
Base image obtained from Google Earth (©2011 Google).

0 50 100
Approximate Scale
1 inch = 100 feet



Questions?

