

ARLINGTON ECHO

Rejuvenate. Enhance. Integrate.

LARC 341
Spring 2017
Studio Professor: Dr. Christopher Ellis
TEAM MEMBERS: Ben Hartmann, Beverly Hernandez, Max Berger, Simone Vitale, Sarah Whiteley
PALS

GOALS

Integrating seamless design to connect all elements of the site
Providing spaces that bridge the gap between the classroom and the outdoors
Transforming the entire site to be completely accessible to individuals of all ages and abilities
Implement a comprehensive and sustainable solution to vehicular and pedestrian circulation

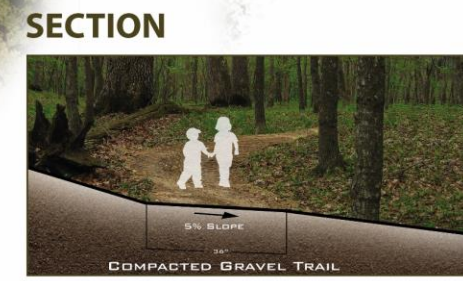
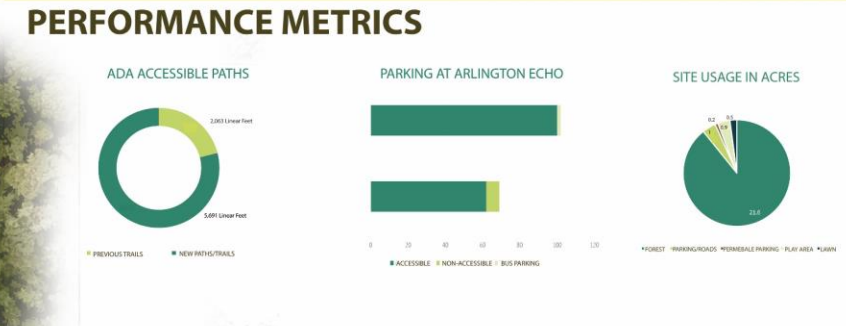
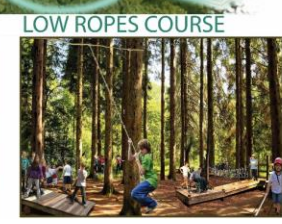
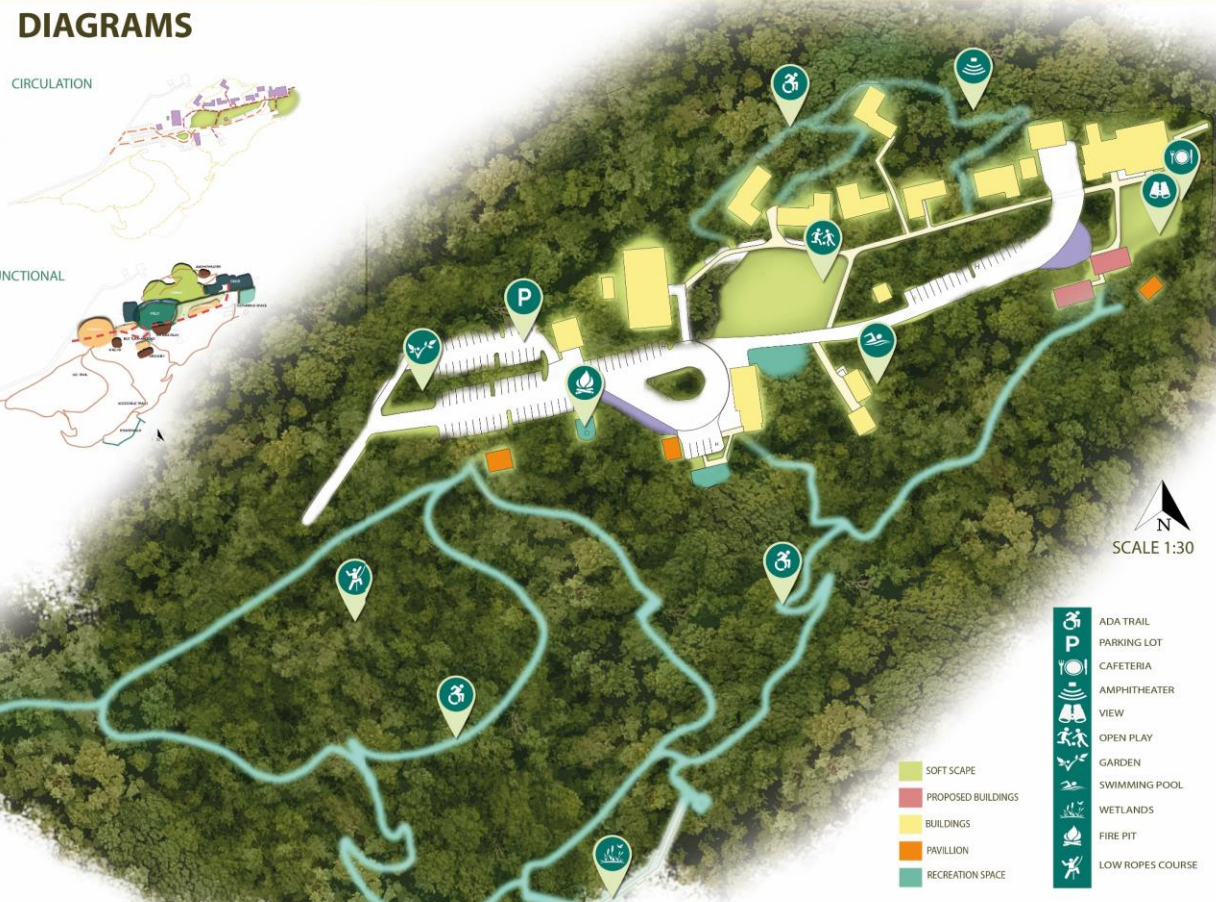
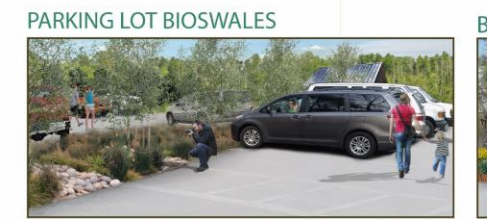

ARLINGTON ECHO

Create a safe environment that accommodates people of all ages, abilities, and backgrounds, all while maintaining the integrity and natural essence of Arlington Echo.

GOALS

- Develop ADA accessibility trails throughout site
- Provide adequate parking
- Maintain the history and natural feel of Arlington Echo

PROGRAM

- Garden
- Wetland
- View
- Parking Lot
- Swimming Pool
- Dining Hall
- Amphitheater
- Open Play
- I&C Course
- ADA Trails
- Non-ADA Trails

DIAGRAMS



INSPIRATION



PERSPECTIVES

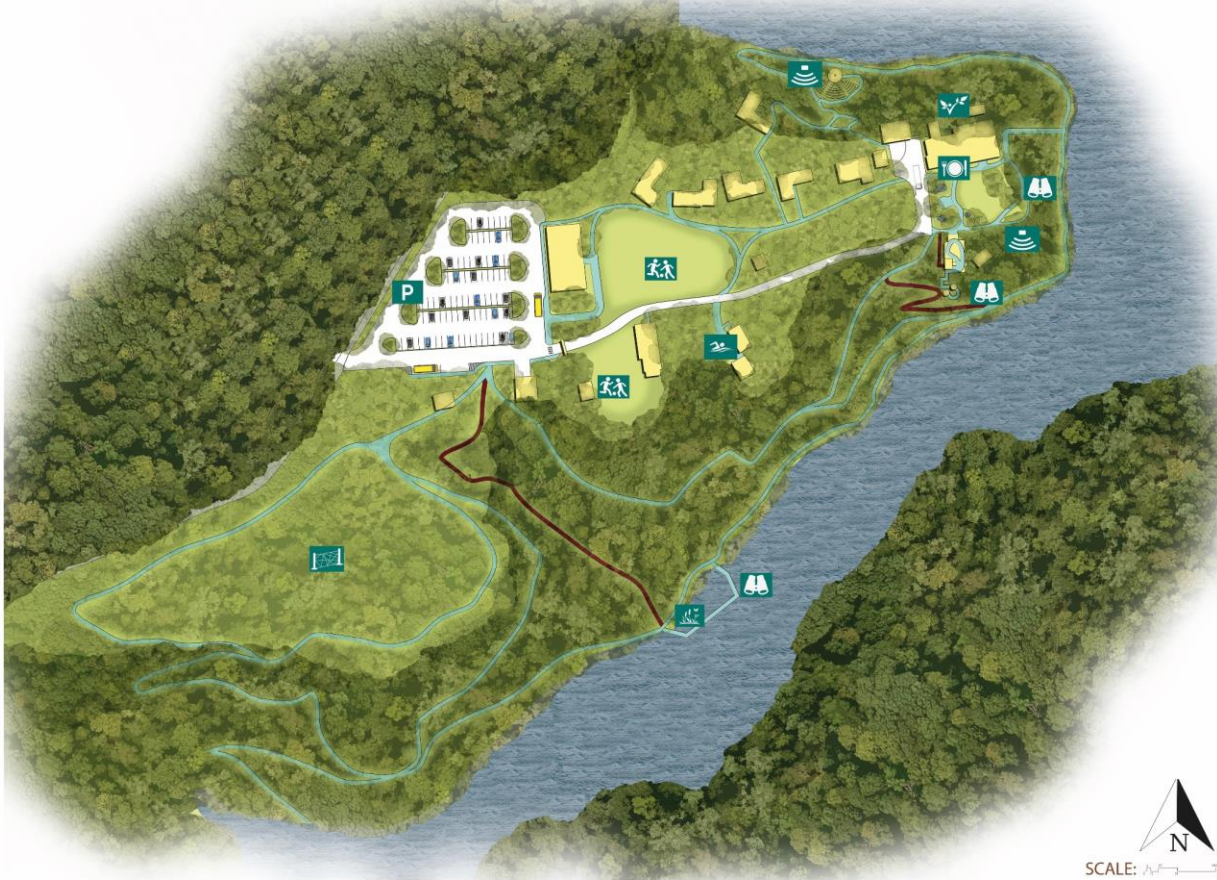

PERFORMANCE METRICS

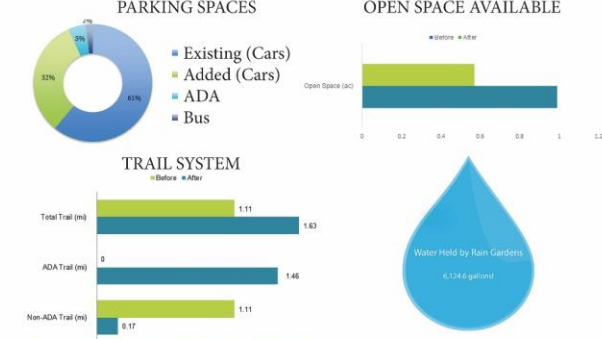

PLANT INSPIRATION

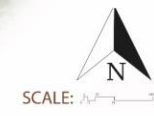

ARLINGTON ECHO



3rd year Landscape Architecture Studio
 Spring 2017
 Studio Professor: Dr. Christopher Ellis
 Team members: Cecilia Tran, Dong Hyun Kim, Akin Jaiye, Garrett Foss, Qi Zhou

GOALS

- Provide stormwater management system throughout campus to narrate the journey of run-off to visiting students.
- Improve open areas, marsh, and shoreline for more outdoor teaching opportunities.
- Expand parking lot to relieve parking and bus arrivals.
- Provide accessible trail systems for all people to enjoy their time at Arlington Echo.

DIAGRAMS



FUNCTIONAL DIAGRAM



HABITAT MAP

INSPIRATIONS



PERSPECTIVES



- RAINWATER BUFFER
- AMPHITHEATER
- VIEW
- RAINWATER SITE
- ADA ACCESSIBLE
- PERMEABLE PAVING
- SWIMMING POOL
- WETLANDS
- CAFETERIA
- GREEN WALL
- OPEN PLAY
- PARKING LOT



SCALE: 1"=161'

PERFORMANCE METRICS

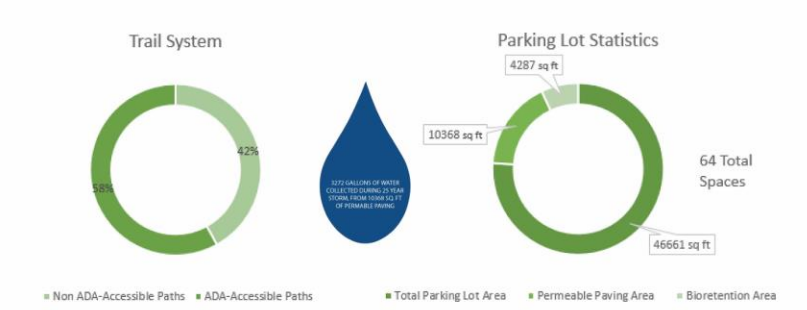

DETAILED PLAN-PARKING



SCALE: 1"=185'

LIVING SHORELINE



ARLINGTON ECHO



LARC341
Spring 2017
Studio Professor: Dr. Christopher Ellis
Steven Palomino, Christopher Snyder, James Schwartz, Sean Quinn, Paul Mayer



GOALS

- Improve ADA accessibility on site for pedestrians
- Increase number of parking spaces while using LID techniques
- Increase on-site learning through memorable experiences
- Create new views
- Enable efficient use of spaces and functionality

SPACE GUIDE

- ADA Trail
- Parking Lot
- Cafeteria
- Amphitheater
- Scenic View
- Floating Wetlands
- Open Play Area
- Rain Garden
- Swimming Pool



PERFORMANCE METRICS

ADA Accessibility



Category	Area
Wetland	1 ac
Play	.2 ac
Meadow	.75 ac
Campus	1.8 ac
Forest	18 ac
Roads	1.75 ac

Arlington Echo Usage



Parking Spaces

Category	Miles
Non-ADA	.226
ADA	1.4

Trail System



60% More Parking

86% ADA Accessible

DIAGRAM



Pedestrian and Vehicle Circulation

INSPIRATION



PERSPECTIVES



Stream Invertebrate Collection

The Nesting Trees

Garden Quad



I + C Loop

River Overlook

Open Field

Pavilion Play

SIGNAGE



WILDLIFE WALK

On days when wildlife may be out of sight, students will still be able to enjoy and learn from the Wildlife Walk exhibit in the Wildlife Center. A boardwalk path on the outside of the building will contain displays of constructed habitats using taxidermy animals



Bonfire Pit



Echo Entry



Bus Pick-Up/Drop-Off

