

Cambridge Renaissance

Sandra Tripp-Jones
City Manager

Council Goals

- **Economic development:**
 - Tourism
 - Thriving downtown
 - Revitalization of the Historic Pine Street District
 - Sailwinds/ Waterfront Development
 - Industry
- **Safe and livable housing for all members of the community.**

Focus Areas

1. Downtown
2. Waterfront
3. Pine Street Historic District
4. Route 50

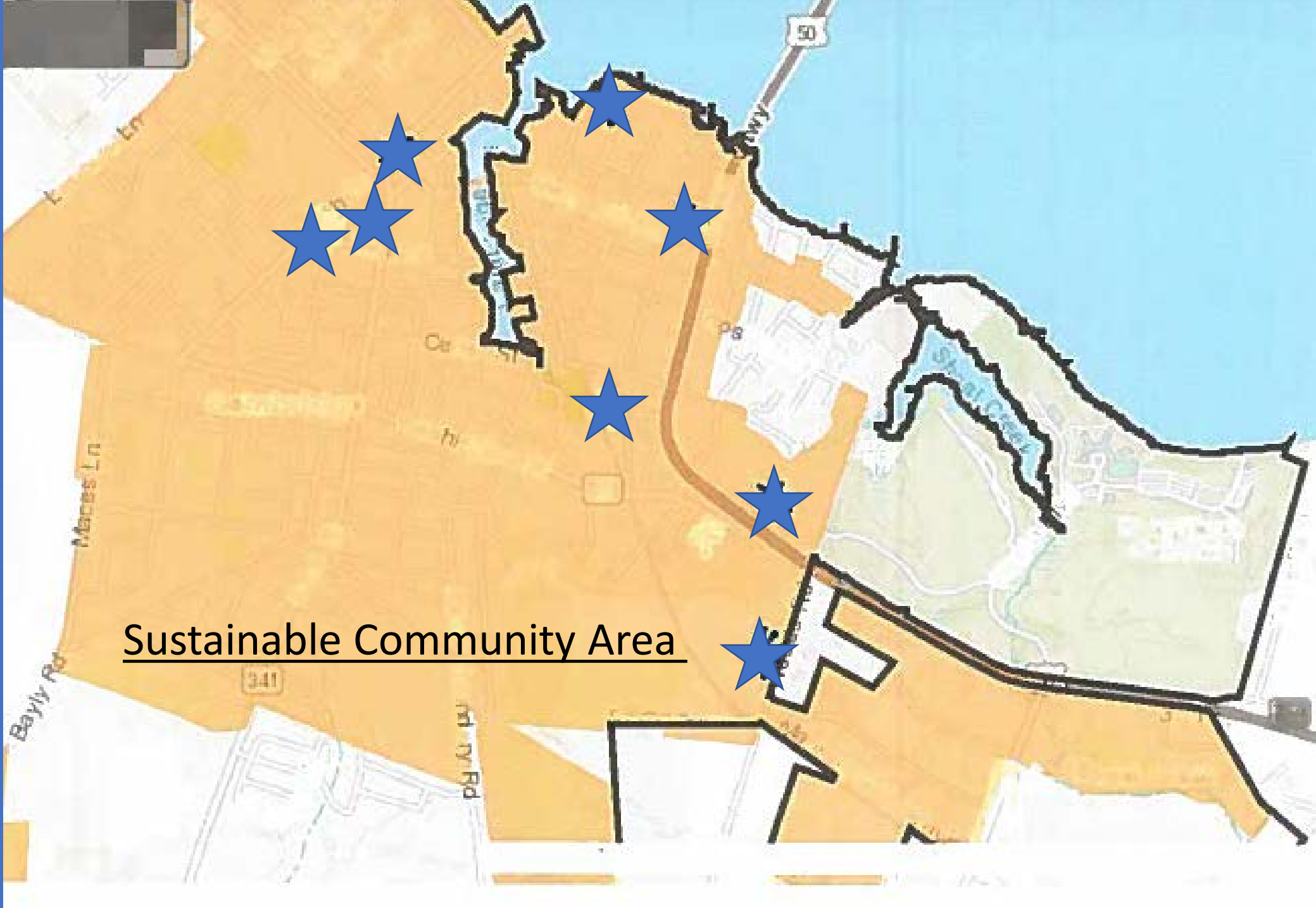

Sustainable Community Area

1. Downtown/Route 50 - Entry

Gateway



Maryland Avenue



1. Downtown

Historic Restorations Mixed Use:

505, 507, 509 Race Street

Partners: County, DHCD, Eastern Shore Land Cons., private developers



1. Downtown

Historic High Street
Repair (\$800,000):



1. Downtown – *Groove City*

RaR



“Main street”



2. Waterfront



**Sailwinds Deep Water
Port Wharf Repair
(\$5.2 million)**

Partners: City and
State

2. Waterfront -Our ship is coming in....



American Cruise Lines



SS John Brown

2. Waterfront

Cambridge Waterfront
Development, Inc.

Partners: City,
County, State, Shore
Regional Health



3. Pine Street Historic District

Started with a
blight study...



3. Pine Street Historic District

Phase 1 Housing
Revitalization - \$1.2 million

Partners: City, Habitat,
DHCD, County

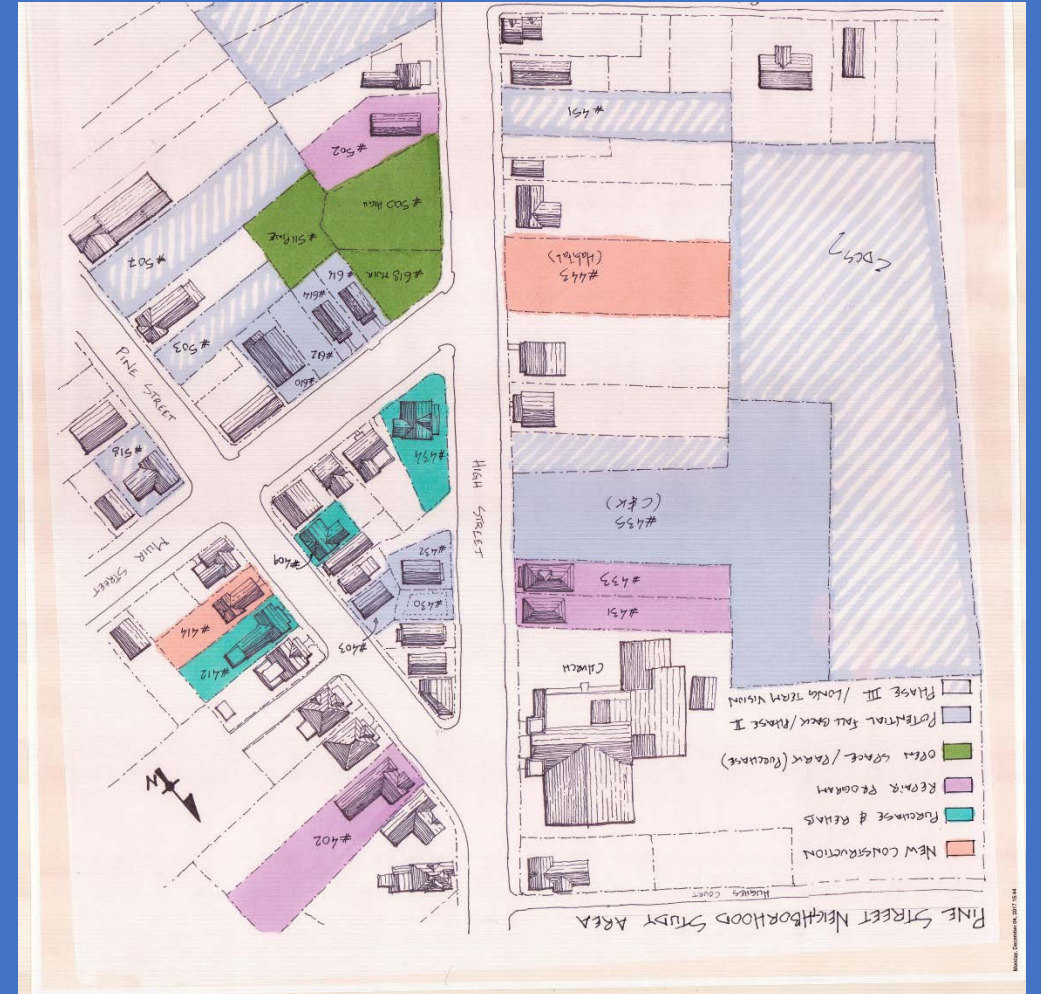

3. Pine Street Historic District

Commercial-Mixed
Use Development:
Beasley Project

Partners: City, DHCD
Developer



3. Pine Street Historic District

Pine Street Streetscape (application)

Partners: City, DHCD

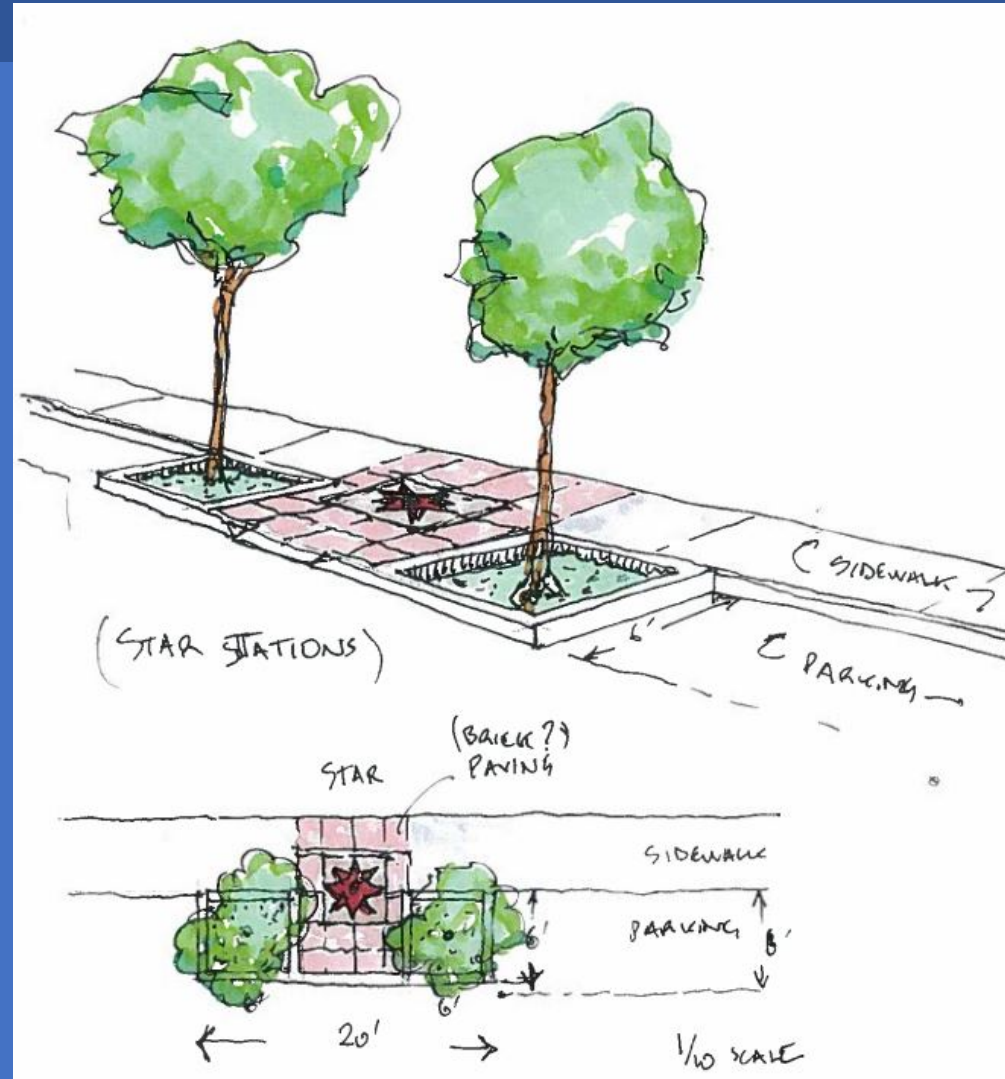

4. Just off Route 50

**Factory F (Phillips
Packing Plant)**

Partners: Eastern Shore Land
Conservancy, Cross Street Partners,
DHCD



4. Just off Route 50

Cannery Park - Stream Restoration

Partners: City,
Eastern Shore
Land
Conservancy,
DNR



4. Just off Route 50

Cannery Park

Partners: City, Eastern Shore Land Conservancy, Cross Street Partners, County



4. Route 50

**Cambridge
Marketplace**

Partners: Charles Fairchild, Shore Regional
Health



4. Just off Route 50

Doctor's Orders – marijuana growing and packing plant



4. Just off Route 50

**Woods Road
Industrial
Development**

Partners:
County, City,
Protenergy



Cambridge Renaissance

Policy:

Council Goals

Partnerships:

**City, County, State,
Not-for Profits, and
Private Sector**

Perseverance:

20 + years

Thank you